

City of Alexandria, Virginia

MEMORANDUM

~~12~~
~~5-28-02~~

26
6-15-02

DATE: MAY 21, 2002

TO: THE HONORABLE MAYOR AND MEMBERS OF CITY COUNCIL

FROM: PHILIP SUNDERLAND, CITY MANAGER *PS*

SUBJECT: STAFF RECOMMENDATIONS ON THE INSTALLATION OF A TRAFFIC SIGNAL AT THE INTERSECTION OF WEST GLEBE ROAD AND OLD DOMINION BOULEVARD

ISSUE: City Council consideration of staff recommendations regarding the installation of a traffic signal at West Glebe Road and Old Dominion Boulevard.

RECOMMENDATION: That City Council:

- (1) receive this report and docket it for public hearing on June 15; and
- (2) at the conclusion of the public hearing, authorize staff to install a traffic signal at the intersection of West Glebe Road and Old Dominion Boulevard.

BACKGROUND: Neighbors in the vicinity of the intersection of West Glebe Road and Old Dominion Boulevard have raised concerns about speeding traffic along West Glebe Road and have requested that the City take steps to control the speeding traffic. The posted speed limit on Glebe Road is 25 miles per hour (mph). Staff's recent traffic surveys show that motorists are traveling an average of 29 mph. The neighbors have also requested that a traffic signal be installed at the intersection of West Glebe Road and Old Dominion Boulevard to assist pedestrians in crossing Glebe Road safely.

Staff has been working with the Upper Potomac West work group for the past several months on a traffic and pedestrian plan for Glebe Road designed to meet the concerns expressed by the neighbors. This plan has a number of recommendations, one of which is the installation of a traffic signal at the intersection of Glebe Road and Old Dominion Boulevard which staff recommends moving ahead with now. The remaining recommendations addressing speeding and parking issues are being developed.

DISCUSSION: Staff performed an engineering study and found that the intersection of Glebe Road and Old Dominion Boulevard meets the criteria established in the Manual of Uniform Traffic Control Devices (MUTCD) for traffic signal installation. Specifically, the volume of traffic on West Glebe Road is high enough to make it difficult for pedestrians to cross the street and for motorists to make turning movements at this intersection.

Installing a traffic signal at this location will require removing 31 feet of parking (or one-and-a-half parking spaces) in front of 700 and 700-A West Glebe Road (see attached diagram). The parking removal is necessary in order to create two lanes (a through lane and a left turn lane) for the east bound Glebe Road traffic approaching the signal. A through lane and left turn lane already exist for the westbound Glebe Road traffic approaching the signal. The Old Dominion Boulevard approaches to the proposed signal will be vehicle actuated. This means that the signal will only cycle when there is traffic on Old Dominion Boulevard. In addition, the City is examining current technology to address speed issues through an additional means of sensor activation. Sensor activation would turn the signal from green to yellow, then red when a vehicle or vehicles are speeding along the West Glebe corridor.

The proposed traffic signal will include pedestrian signals to allow pedestrians to cross West Glebe Road safely. The next closest signal where pedestrians can cross is at Russell Road which is nearly a quarter of a mile away. This is too far to expect pedestrians destined for Old Dominion Boulevard to walk in order to safely cross the street. The proposed signal is not expected to create excessive delays on Glebe Road.

The Upper Potomac West work group, Lennox Place, and the North Ridge and Brighton Square civic associations support the proposed traffic signal. This issue was brought before the Traffic and Parking Board at its April 22, 2002 meeting. Mr. Ruggiero made a motion to deny the request that was seconded by Mr. Johnson. The reason for this motion is that some members of the Board felt that the speeding issue should be addressed before installing a traffic signal. The motion to deny the request failed. The Board approved the staff recommendation by a vote of 4-2.

It should be noted that the Police Department has initiated numerous speeding enforcement details at this location, and so far this year has issued 278 speeding tickets between the 500 and 800 blocks of West Glebe Road. Police enforcement is limited by the resources available, and the proposed traffic signal will enhance the City's ability to control speeding at all hours, especially when Police are not present to enforce speeding limits.

At the Traffic and Parking Board meeting, several residents who live in the houses on West Glebe Road near the proposed signal expressed concern about being able to safely exit their driveways when traffic is stopped at the proposed signal. With no traffic signal these residents say it is difficult to exit their driveways because of the speed and volume of traffic. These residents are concerned that when the traffic signal is operational exiting their driveways will be more difficult. Staff acknowledges that there will be times when traffic waiting for the signal will momentarily block the driveways. However, based on the 24-hour traffic volume study, this is not expected to be a significant problem. Also, the signal will be vehicle actuated on Old Dominion Boulevard; consequently, the signal will only turn red for Glebe Road when there is demand on Old Dominion Boulevard. Staff believes that the proposed signal will make it easier to exit the driveways because the speed of traffic will be slower.

FISCAL IMPACT: The construction cost of the traffic signal is estimated to be \$80,000. This will be funded through the reprogramming of funds from a Capital Improvement Project for Bridge Repair and Rehabilitation that has been postponed pending State revisions to the project. These funds have already been allocated by City Council.

ATTACHMENTS:

Attachment 1. Diagram showing the removal of parking on Glebe Road

STAFF:

Richard Baier, P.E., Director, Transportation and Environmental Services

Douglas McCobb, P.E., Deputy Director, Transportation and Transit Services, T&ES

Alfred Coleman, Budget/Management Analyst, OMB

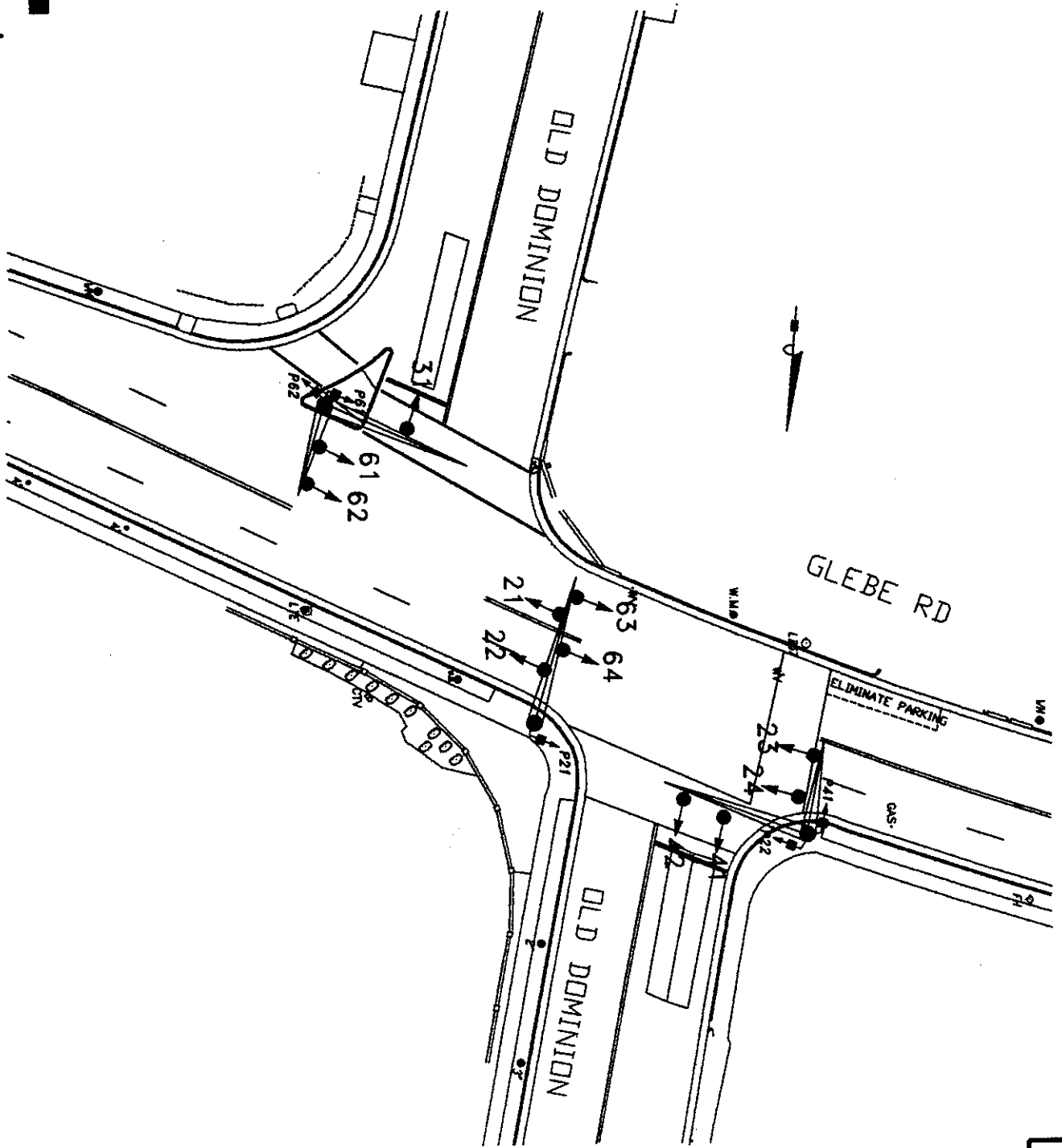

0' 20' 40'



INTERSECTION: Glebe and Old Dominion

INIT: qcsr DATE: 05-10-02

4

June 13, 2002

TO: Mayor Kerry Donley and Alexandria City Council Members

FROM: Barbara P. Hayes
3603 Old Dominion Boulevard, Alexandria 22305

SUBJECT: Traffic Signal at the Intersection of West Glebe Road and
Old Dominion Boulevard
(June 15 Public Hearing Meeting, Item 26)

I support the installation of this traffic signal. The reasons are enumerated on the attached petition, which I drafted. Several other people are gathering signatures on their streets, and there should be more petition pages at the Public Hearing Meeting.

I would like to elaborate on the reasons a little. I have been retired for two years, but commuted using the Dash bus before that. Crossing West Glebe Road to get to the bus stop was dangerous, due to the volume and speed of traffic on West Glebe Road. The curve coming from the direction of Virginia Power meant you couldn't always see oncoming traffic, and I often ended up running to make it across. In the two years since I retired, this situation has gotten worse.

Besides commuters, there are a number of people who live on the Arlandria side of West Glebe Road but park on the Beverley Hills side, due to lack of parking in Arlandria. These people cross West Glebe Road twice a day (going home and coming back for their cars), often with children. I worry about their safety.

Turning right from Old Dominion Boulevard onto West Glebe Road is usually not difficult, but turning left requires a considerable amount of waiting. Both lanes are rarely clear at the same time. Again, the curve and the speed of traffic adds an element of danger.

People were eager to sign the petition. Some do not live close to the intersection, for example people connected with the preschool at the church. When someone told me they did not live in the neighborhood, I asked if they used the intersection regularly. If the answer was "no", I suggested they not sign the petition. But if the answer was "yes" and they wanted to sign, I encouraged them to do so.

I feel the traffic signal would help alleviate these dangerous conditions. Thank you for your consideration of it.

Barbara P. Hayes

To: The Alexandria City Council
 Subject: Traffic Signal at Old Dominion Boulevard and West Glebe Road

We, the undersigned, support the installation of a traffic signal at the corner of Old Dominion Boulevard and West Glebe Road for the following reasons:

1. It is increasingly difficult to exit from Old Dominion Boulevard safely, whether turning onto West Glebe Road or crossing it, due to both the volume and speed of traffic on West Glebe Road.
2. It is almost impossible for pedestrians to cross West Glebe Road safely. Pedestrians are almost entirely composed of commuters who take the Dash bus or people who park in the Beverley Hills area but live on the north side of West Glebe Road; these people cross West Glebe Road twice a day.
3. A traffic signal should help slow down and control the traffic on West Glebe Road.

Name	Address
Barbara P Hayes	3603 Old Dom. Blvd
Sarah Higgins	412 Tennessee Ave.
Maria Perez	618 NOTABENE DR.
LESLIE HAGAN	468 WEST GLEBE RD
Sissy Walker	Beverley Hills Church Preschool ^{3512 Old Dominion}
Alerie Murphy	3103 Russell Rd
Karin Fitzgerald	2505 E. Randolph Ave.
Kathleen Edgust	6060 N. 25 th RD. ARLINGTON, VA.
Michael J. Oliver	3113 Circle Hill Road, Alexandria, VA
Loren E Swatt	506 Tennessee Ave, Alexandria, VA
Dan Melchior	506 Tennessee Ave, Alexandria, VA
Dee M. Pro	811 Beverley Dr., Alexandria, VA
Aileen LaHanza	2914 Mayer Place, Alexandria VA
Harriet C Hagen	3420 Old Dominion Blvd -
Diana Reynolds	309 Lloyds Lane
Robert Miller	801 Chalfont Drive
Beth Ladd	806 Enderby
BRENT SAHLER	3302 ELMORE DR
Way J. Kiri	3307 Elmore Dr.

To: The Alexandria City Council
 Subject: Traffic Signal at Old Dominion Boulevard and West Glebe Road

We, the undersigned, support the installation of a traffic signal at the corner of Old Dominion Boulevard and West Glebe Road for the following reasons:

1. It is increasingly difficult to exit from Old Dominion Boulevard safely, whether turning onto West Glebe Road or crossing it, due to both the volume and speed of traffic on West Glebe Road.
2. It is almost impossible for pedestrians to cross West Glebe Road safely. Pedestrians are almost entirely composed of commuters who take the Dash bus or people who park in the Beverley Hills area but live on the north side of West Glebe Road; these people cross West Glebe Road twice a day.
3. A traffic signal should help slow down and control the traffic on West Glebe Road.

Name	Address
Lorraine Keir	3307 Elmore Drive, Alex
Steven Lustig	3410 Old Dominion Blvd Alex
Jill Canfield	3410 Old Dominion Blvd - Alex
Wylie Rowson	714 S. Overlook
Sarah Conrad	3516 Halcyon Dr. Alex VA
Tracy & Carl	"
Dan & Dawn	3306 Cameronville
Eloise Patterson	3415 Halcyon Dr.
Carol Simon-Hiddens	3413 Halcyon Drive, Alex.
Juan P. Case	3410 Halcyon Dr Alex
Darlene Meggesto	3305 Old Dominion Blvd
Lou Barber	900 Crescent Drive Alex, VA
Chris Krese	810 Chalfonte Dr. Alexandria
Jolie Thompson	3401 Old Dominion Blvd Alex.
Daniel Thompson	3401 Old Dominion Blvd
Debbie Keefe	6014 Oakland Terrace
Mary B. M. Cornish	3401 Ala. Ave.
John & Judy	700 South Overlook Dr.
Samantha Johnson	3601 Norris

To: The Alexandria City Council
 Subject: Traffic Signal at Old Dominion Boulevard and West Glebe Road

We, the undersigned, support the installation of a traffic signal at the corner of Old Dominion Boulevard and West Glebe Road for the following reasons:

1. It is increasingly difficult to exit from Old Dominion Boulevard safely, whether turning onto West Glebe Road or crossing it, due to both the volume and speed of traffic on West Glebe Road.
2. It is almost impossible for pedestrians to cross West Glebe Road safely. Pedestrians are almost entirely composed of commuters who take the Dash bus or people who park in the Beverley Hills area but live on the north side of West Glebe Road; these people cross West Glebe Road twice a day.
3. A traffic signal should help slow down and control the traffic on West Glebe Road.

Name	Address
Mildred A. Murchony	706 S Overlook Dr
Karen Kvittem	3411 Alabama Ave
Robert Meyers	3411 Alabama Ave
Philip Anderson	705 Grandview Dr
MIKE FALLON	7025 Overlook Dr
GESTYAN FALLON	7025 Overlook Dr
CHARLOTTE FALLON	7025 Overlook Dr
Barbara Glomb	403 Tennessee Ave.
Steve Glomb	403 Tennessee Ave.
Kathleen Beech	401 Tennessee Ave.
Greg Mitsoff	360 Norris Place
GREG MITSOFF	3603 NORRIS PLACE
Julie Carey	3506 Norris Place
Janet Anderson	3502 Norris Place
J.P. Darr	3604 Norris Place
L.A. Wilson	398 TENN. AVE.
Steve Clark	399 Tenn. Ave
Beja A. Gungor	400 TENN AVE
Ken Williams	409 TENN AVE

To: The Alexandria City Council
 Subject: Traffic Signal at Old Dominion Boulevard and West Glebe Road

We, the undersigned, support the installation of a traffic signal at the corner of Old Dominion Boulevard and West Glebe Road for the following reasons:

1. It is increasingly difficult to exit from Old Dominion Boulevard safely, whether turning onto West Glebe Road or crossing it, due to both the volume and speed of traffic on West Glebe Road.
2. It is almost impossible for pedestrians to cross West Glebe Road safely. Pedestrians are almost entirely composed of commuters who take the Dash bus or people who park in the Beverley Hills area but live on the north side of West Glebe Road; these people cross West Glebe Road twice a day.
3. A traffic signal should help slow down and control the traffic on West Glebe Road.

Name	Address
Judy Lewis	408 Tennessee Ave
Linda Johnson	810 Enderby Dr
Garry Turner	3301 Old Dominion
Lilly Davis	3301 Old Dominion
Deborah Matchee	319 Kentucky Ave.
Theresa [unclear]	319 Kentucky Ave
Susan Antucha	3503 HALEYON
Genevieve Heisley	710 Chalfonte Dr.
Pia [unclear]	3302 Old Dominion
BRITT-MARIE [unclear]	3304 Old Dominion
Ellen Lane Moore	3213 Old Dominion
ROBIN ROBERTS	3204 OLD DOMINION BLVD
Kunelde Bliss	317 Kentucky Ave.
A. Tracey	614 Beverley DR.
S Fairbanks	313 Kentucky Avenue
Gina Clark	3315 Old Dominion Blvd
John Ford	3417 ACABAMA AVE
Julie Fortu	3315 Old Dominion Blvd
William [unclear]	706 S Overlook DR

To: The Alexandria City Council
 Subject: Traffic Signal at Old Dominion Boulevard and West Glebe Road

We, the undersigned, support the installation of a traffic signal at the corner of Old Dominion Boulevard and West Glebe Road for the following reasons:

1. It is increasingly difficult to exit from Old Dominion Boulevard safely, whether turning onto West Glebe Road or crossing it, due to both the volume and speed of traffic on West Glebe Road.
2. It is almost impossible for pedestrians to cross West Glebe Road safely. Pedestrians are almost entirely composed of commuters who take the Dash bus or people who park in the Beverley Hills area but live on the north side of West Glebe Road; these people cross West Glebe Road twice a day.
3. A traffic signal should help slow down and control the traffic on West Glebe Road.

Name	Address
Roy TRAMGOTT	2417 CENTRAL AVENUE 22302
Paul NORMAND	915 ALLISON ST 22302
Warren Lutz	505 Woodland Terrace, Alex "
MARG LINDA OLIVER	3113 Circle Hill Rd. Alex, 22305
Steve Steve Najarian	1426 Dogwood Dr. Alex 22302

26
6-15-02

**PETITION
AGAINST THE INSTALLATION
OF A TRAFFIC LIGHT AT WEST GLEBE ROAD
AND OLD DOMINION BOULEVARD**

We, the undersigned, oppose the installation of a traffic light at West Glebe Road and Old Dominion Boulevard, Alexandria, VA. We firmly believe a light is not the best means to slow down traffic on West Glebe Road. We believe speed tables would be a more effective speed-calming mechanism, without the congestion, vehicle stagnation, parking space reduction and pollution a traffic light would produce. We ask the City of Alexandria to please consider the installation of speed tables in place of the traffic light.

NAME	ADDRESS	DATE
Laurie Hieta Laurie Hieta	710 W. Glebe Rd, Alex	6/11/02
Laura Cullen	708 W GLEBE RD, ALEXANDRIA	6/11/02
Noel + Janina Lee	712 W. GLEBE RD. ALEX, VA	6/11/02
JEFF ERTMAN Jeff Ertman	3803 FLORENCE DR ALEX ^{VA}	6/11/02
Vera Draka	3803 Florence Dr. Alex.	6/11/02
METROOB AHMED	712 A. W. GLEBE RD ALEX	6/11/02
Marian Elmirance	712 A W. Glebe Rd. Alex. VA	6/11/02
Norman Hieta	710 W Glebe Rd Alex, Va	6/12/02
Khalysa Gurd	707 W. Glebe Rd Alex ^{VA}	6/12/02
Rob W. W. W.	707 W Glebe Rd Alex Va	6/12/02
Robert W. W.	697 W. GLEBE RD ALEX	6/12/02
Joseph W. W.	11 " " " "	6/12/02
Ann L. G. G.	689 W. Glebe Rd	6-12-02
Edith Osterz	714 West Glebe Rd	6/13/02
Eladio Contreras	720 W. Glebe RD. #3B	6/17/02

**PETITION
AGAINST THE INSTALLATION
OF A TRAFFIC LIGHT AT WEST GLEBE ROAD
AND OLD DOMINION BOULEVARD**

We, the undersigned, oppose the installation of a traffic light at West Glebe Road and Old Dominion Boulevard, Alexandria, VA. We firmly believe a light is not the best means to slow down traffic on West Glebe Road. We believe speed tables would be a more effective speed-calming mechanism, without the congestion, vehicle stagnation, parking space reduction and pollution a traffic light would produce. We ask the City of Alexandria to please consider the installation of speed tables in place of the traffic light.

NAME	ADDRESS	DATE
DONNA M. LAFOURAIN <i>Donna M. LaFournain</i>	704-A W. GLEBE	6/11/02
JEANNE A. MANN <i>Jeanne Mann</i>	706 W. GLEBE RD	6-11-02
Jacquelyn Grady <i>Jacquelyn Grady</i>	700 W. Glebe Rd	6-11-02
ANTHONY W. GRADY <i>Anthony W. Grady</i>	700 W. GLEBE RD.	6-11-02
Jim Branch	708 W. Glebe Rd	6-11-02
Sinda M. Lee	3820 Charles Ave.	6-12-02
Lestie S. Lee	3820 Charles Ave.	6-12-02
R. G. Strahler	3811 Courtland Circle	6-12-02
Cheryl Rasek	3828 Charles Ave	6-12-02
MARK FRICK	3830 CHARLES AVE.	6-12-02
Colleen M. [unclear]	3830 Charles Ave	6-12-02
Old [unclear]	3812 Charles Ave	6-12-02
Kiandra Logan	3812 Charles Ave	6-12-02
Karen Mincoveq	3822 Charles Ave	6-12-02
[unclear]	3812 Charles Ave,	6-12-02

**PETITION
AGAINST THE INSTALLATION
OF A TRAFFIC LIGHT AT WEST GLEBE ROAD
AND OLD DOMINION BOULEVARD**

We, the undersigned, oppose the installation of a traffic light at West Glebe Road and Old Dominion Boulevard, Alexandria, VA. We firmly believe a light is not the best means to slow down traffic on West Glebe Road. We believe speed tables would be a more effective speed-calming mechanism, without the congestion, vehicle stagnation, parking space reduction and pollution a traffic light would produce. We ask the City of Alexandria to please consider the installation of speed tables in place of the traffic light.

NAME	ADDRESS	DATE
Melissa Johnson	3818 Charles Ave	6/12/02
Tatyan	3818 Charles Ave	12 June 02
Leslie Lee		
Reginae Lynn Smith	702-A W. Glebe Rd.	6/14/02
Dennis Smith	702-A W. Glebe Rd.	6/14/02
Michael Randall	704 W. Glebe Rd	6/14/02
Tony Randall	404 W. Glebe Rd	6/14/02
David W. Henry	4445 S. 36th. ST.	6/14/02

26
6-15-02

3803 Brighton Court
Alexandria, Virginia 22305
June 12, 2002

The Honorable Kerry Donley
Mayor
City of Alexandria
301 King Street
Room 2300
Alexandria, Virginia 22314

Dear Mayor Donley:

I would like to express my support for the proposed traffic light at the corner of West Glebe Road and Old Dominion Boulevard. This proposal is contained in Docket Item #26, which will be voted on at a public hearing at the June 15th City Council meeting.

As a long-time resident of Brighton Court, which borders on West Glebe Road, I've been deeply concerned about the vehicular and pedestrian safety on this street. These concerns have been echoed by the Upper Potomac West Task Force, on which I serve. Actions taken by that group support the traffic light and the more comprehensive and well thought out traffic calming plan developed for West Glebe Road by Mr. Richard Baier and his staff at the City's Transportation and Environmental Services Division. The Brighton Square Homeowner's Association also voted to support the staff recommendations.

The proposed light and more extensive traffic calming plan would help alleviate some of the problems which have existed on West Glebe Road for a long time. In the nearly twenty-two years that I've lived at Brighton Square, there have been numerous accidents on West Glebe Road. According to city records, 68 accidents occurred in 1998 and 63 accidents in 2001. It is virtually impossible to cross the street without taking your life in your hands. The *average* speed on this road, which curves in certain spots, thereby limiting visibility, is 37 miles per hour in a 25 miles per hour zone. With several school bus routes and one commuter bus route utilizing West Glebe Road, the chances of a pedestrian accident (which we have luckily been spared so far) increases each day.

At Brighton Square, we have had **four** car crashes through the brick wall surrounding our development in the last four years. Two of these crashes have occurred in the last six months, with the last one occurring as late as this past Sunday afternoon. The car ended up at an angle to the entrance of the driveway, blocking much of the entrance. I shudder to think of what would have happened if one of our Brighton Square residents had been trying to cross the street or attempting to depart the driveway onto West Glebe Road!! I am enclosing, for your information, photographs showing the December, 2001 crash

(when an SUV went through our wall), what the wall looked like then, and the most recent damage incurred on June 9, 2002.

I am optimistic that the City Council will approve the proposed light at the intersection of Old Dominion Road and West Glebe Road and support further recommendations of city staff to improve the overall safety of West Glebe Road. If you wish to discuss any aspect of this letter, you can reach me at (703) 739-0077. Thank you.

Sincerely yours,

A handwritten signature in cursive script, appearing to read "Wilma C. Probst".

Wilma C. Probst

cc: Richard Baier
Sgt. Paul Story

Enclosures







26
6-15-02

3818 Brighton Court
Alexandria, Virginia 22305
June 12, 2002

The Honorable Mayor and Members of City Council
301 King Street
Room 2300
Alexandria, Virginia 22314

Mayor Donley and Members of City Council:

The Brighton Square Homeowners Association enthusiastically supports Docket Item #26, "Staff Recommendations on the Installation of a Traffic Signal at the Intersection of West Glebe Road and Old Dominion Boulevard." This docket item will be voted on at a public hearing at the June 15th City Council meeting.

Some of the members of our Homeowners Association have worked closely with staff of the Transportation and Environmental Services (T&ES) Division to come up with a solution to the safety issues associated with West Glebe Road. We consider this light to be the first step in ensuring the safety of the residents of our community. We are hopeful that additional plans to calm the traffic on West Glebe Road will also be adopted in the near future. We at Brighton Square are particularly concerned about the safety of our community. Cars driving on West Glebe Road have crashed through our brick wall four times in the last four years. With increased traffic (22,000 vehicles per day!) on West Glebe Road, three of these accidents have occurred in the last two years. The most recent accident was last Sunday, June 9th. We are concerned that our insurance premiums will be raised or, even worse, cancelled. With this track record of accidents, it could be difficult for us to obtain new homeowner's insurance.

I can be reached at (703) 683-2949 if you wish to discuss either the Brighton Square accidents or the general traffic conditions on Brighton Square further. Thank you.

Sincerely yours,



Tina Richardson Jones
President, Brighton Square
Homeowners Association

cc: Richard Baier
Sgt. Paul Story

#26

4-22-02

TO: Traffic and Parking Board
And
Department of Transportation and Environmental Services

FROM: Traffic Committee, North Ridge Citizens' Assn.

SUBJECT: Public Hearing on a proposal for a traffic light at the corner of West Glebe Road and Old Dominion Blvd.

DISCUSSION: From time to time over the past several years, neighbors in the North Ridge area have urged installation of a traffic light at the corner of West Glebe Road and Old Dominion Blvd. In the past, City officials did not consider the volume of traffic on Old Dominion heavy enough to warrant a light. That seems to have changed dramatically, and the Traffic Committee of the North Ridge Citizens' Association takes this opportunity to support a proposal for a light. We understand that the light will have cycles that allow protected left turns and a pedestrian pushbutton for pedestrians to cross safely. The corner is a busy one, with bus stops on opposite sides of West Glebe and a moderate amount of pedestrian traffic to and from the commercial center on Mount Vernon Avenue.

The timing of the hearing did not allow us to canvass North Ridge neighbors on the idea, but our memory tells us that there was a consensus over the years in favor of some traffic control at the intersection. The only objection that comes to mind was from a neighbor on West Glebe who feared the light would back cars up past her driveway and make it hard for her to exit the driveway, particularly during rush hour.

Thanks for your consideration of this matter. If you have questions, please contact our Committee Chair, Bill Clayton, at (703) 548-0958.

William E. Clayton Jr., Chair _____

*** **